

Welcome to the Key Stage 4 Options Event 2022

Mr Davies (Headteacher), Ms Horton (Assistant Headteacher), Mr Elsby (Head of Year 9)

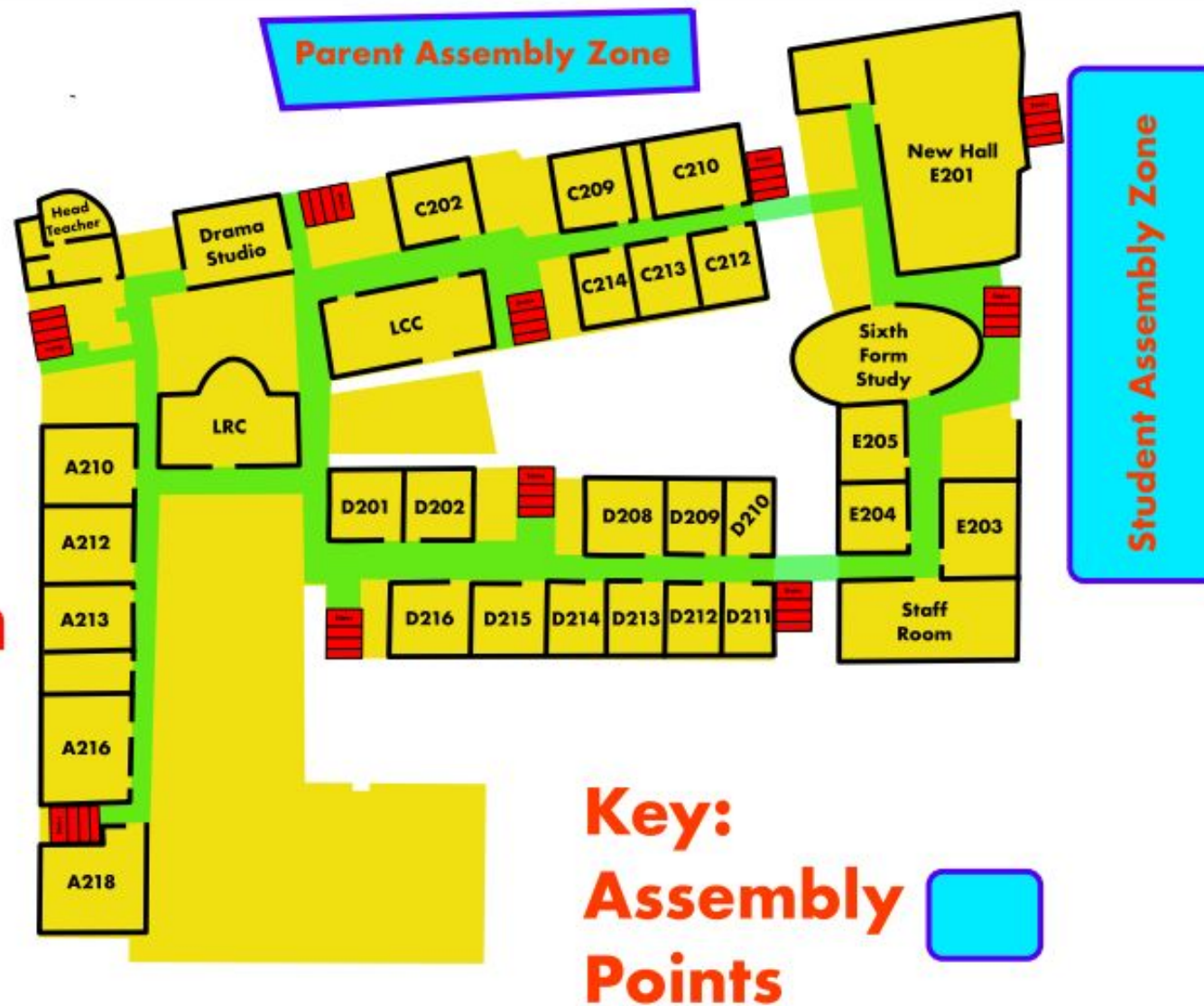

Fire Action



Start of a new phase

- A curriculum journey
- New phase Key Stage 4 – Years 10 & 11
- Opportunity to review and look forward

Curriculum Principles

- A curriculum that is ambitious and challenging
- A curriculum designed to raise the aspirations and ambitions of our students
- A curriculum that has a love of learning and a passion for subjects at its heart
- A curriculum that is broad and balanced

What to expect at KS4

- Foundations for KS4 curriculum will commence in summer term and in some cases, have already started
 - Citizenship the most obvious example of this
- Coursework/practical assessment in some GCSEs
- Full range of learning activities
- Increased homework – organisation needed!
- Individual support from subject teachers
- Monitoring and mentoring
- Responsibilities and opportunities outside of the classroom
- Preparation for Key Stage 5

Key Stage 4

- GCSEs – General Certificate of Secondary Education
- Alternative qualifications



Everyone studies...

- ☐ English Language (GCSE) and English Literature (GCSE)
- ☐ Mathematics (GCSE)
- ☐ Science – Combined (two GCSEs) or Triple (three GCSEs)
- ☐ Citizenship (started in Year 9)
- ☐ Physical Education
- ☐ Three options (GCSE and/or GCSE equivalent)

Making choices

Consider:

- What do you enjoy?
- Have you looked at the course information in the options booklet?
- Have you spoken to staff and student leaders?
- How much coursework/practical assessment is there - and does this play to your strengths?
- Will it combine well with other subjects?
- What do you need to come to RHS Sixth Form?
- Have you picked a **range** of subjects to make sure you have kept your future options open?

Don't:

- Choose a subject because your friend is;
- Choose a subject that's new without finding out about it;
- Choose subjects because you think they are 'easy' or an opportunity to unwind/relax;
- Choose subjects that are unsuited to your natural skillset (Drama/Art/Music);
- Choose a subject because you think a particular teacher will or won't be teaching it.

Year 10 Subject Choice Form & Procedure

2022-2024

www.tinyurl.com/ruisliphighoptions2022

You don't have to pick subjects at the expense of another!

Choose ONE subject from the left hand column and the remaining FOUR from the right hand column so you have FIVE in total.

GCSEs

French
Spanish
Latin
Computer Science
History
Geography

GCSEs

Art and Design - one of either:

- Fine Art
- Textile Design

Computer Science
Drama
French
Geography
History
Latin
Media Studies
Music
PE
Spanish

Vocational subjects

Enterprise and Marketing (OCR Cambridge Nationals)
Health and Social Care (BTEC Tech Award)
Sport (BTEC Tech Award)
Travel and Tourism (BTEC Tech Award)

Please be aware that if only a small number of students select an option, it is likely not to take place.

This is why we ask students to make five choices in order of preference.

Think carefully

- Consider your choices very carefully (including the fourth and fifth ones)
- Options to be selected by *Thursday 31st March 2022*
- Some students will then have one-to-one meetings with specific members of staff; students will be selected for these if their choices need to be discussed further
- Options will be confirmed once we have considered all students' choices next half term





Return to the
**FAIRYTALE
FOREST**

THERE'S NOT LONG UNTIL THE FESTIVE
SEASON SO JOIN US FOR...

**THE CHRISTMAS EXTRAVAGANZA
OF THE YEAR*!**

*IN MARCH

PERFORMANCE DATES:
WEDNESDAY 30TH MARCH AT 5:30PM
THURSDAY 31ST MARCH AT 5:30PM

TICKETS:
ADULTS £7 (£8 ON THE DOOR)
STUDENTS £4 (£4.50 ON THE DOOR)

TICKETS ARE AVAILABLE TO PURCHASE VIA PARENTPAY

The RHS school production
of **'Return to the Fairytale
Forest'** is taking place next
week on **Wednesday 30th
March and Thursday 31st
March.**

Don't miss out on the
event of the Christmas
season (yes, we know it's
March).

Students - £4 (£4.50 on the
door)
Adults - £7 (£8 on the
door)

**Tickets can be purchased
via ParentPay.**

For more information
please see Mrs Ohana or
Mr Randall.